

RPT-M1012P-4G-T-X2 | 12 Port Industrial Unmanaged PoE+ M12 Switch

FEATURE HIGHLIGHTS



- 8x 10/100T(x) M12 connector with IEEE 802.3at PoE+
- 4x 10/100/1000T(x) M12 connector
- Support Bypass function
- IP40/IP54(Optional) housing
- EN50155, EN45545-2 railway certificates
- Compliant with ITxPT, E Mark for public transport
- Operating in wide temperature
- Isolated redundant PoE power 190W

DESCRIPTION

Sbjlink's RPT-M1012P-4G, featuring 8 x Fast Ethernet ports and 4 x Gigabit uplink ports, are all designed with M12 connectors for vehicle application. The 8 fast ethernet ports provide 30W per port for PoE function. The 4 giga uplink ports with relay bypass function support non-stop communication while no power exists.

The power input of RPT-M1012P-4G has redundant dual power inputs supporting 24-48VDC for most of the vehicles and high power input version, between 72V-110VDC. Operating temperature is extended between -40 degree C and 75 degree C. These are applicable on the vehicles and railway application.

To fit the on-board installation, the enclosure is slim and compact with IP40 and IP54 housing options. RPT-M1012P-4G series all have EN50155 and EN45545-2 certificates for railway and E Mark for bus application. ITxPT is also design compliant to increase the interoperability with IT network for public transport.

This switch can be an purely unmanaged switch without PoE and capable to modify into a web smart switch that enable IEEE 802.3x and provide flow control function.

RPT-M1012P-4G-T-X2 | 12 Port Industrial Unmanaged PoE+ M12 Switch

SPECIFICATIONS

Technology	
Standards	IEEE 802.3 10BaseT
	IEEE 802.3u 100BaseTX
	IEEE 802.3ab 1000BaseT
	IEEE 802.3f Power over Ethernet
	IEEE 802.3t PoE+
Processing Type	Store and Forward
Switch Properties	
Switch Fabric	9.6Gbps
Priority Queues	-
MAC Table Size	8K
Packet Buffer	4Mbits
Interface	
Network Connector	8 x 10/100T(x) M12 Female D-coded 4-pole, 4x 10/100/1000T(x) M12 Female X-coded 8-pole, auto negotiation speed duplex mode, auto MDI/MDI-X
LED Indicators	Per unit: PWR1, PWR2, Status
	Ports: Link/Active
	PoE: Output Power
Power Requirements	
Operation Voltage	LV: 24VDC, 48VDC, HV: 72-110VDC Redundant dual inputs
Connection	M12 Male S-coded 4-pole
Power Consumption	15W without PD's consumption
PoE Power Budget	Max. 30W per PoE port. Max. total output power for PD: 165W@24V input (normal temp.); 75W@24V input (75°C)
Protection	Overload Current Protected, Reverse Polarity Protected
Mechanical Construction	
Enclosure	SECC
Protection Class	IP40/IP54(Optional)
Dimensions	181x99x94 mm (WxHxD)
Weight	1.20 kg
Mounting	Wall Mounting Kits, Optional DIN-Rail Mounting
Environmental Limits	
Operating Temperature	Extended: -40°C ~ 75°C (-40°F ~ 167°F)
Storage Temperature	-40°C ~ 85°C (-40°F ~ 185°F)
Ambient Relative Humidity	5 to 95%, (Non-Condensing)

Email: sales@sbjlink.com

Website: www.sbjlink.com

RPT-M1012P-4G-T-X2 | 12 Port Industrial Unmanaged PoE+ M12 Switch

SPECIFICATIONS

Regulatory Approvals	
EMI	FCC Part 15 Subpart B Class A
	CE EN 55032 Class A
EMS	IEC61000-4-2 (ESD)
	IEC61000-4-3 (RS)
	IEC61000-4-4 (EFT)
	IEC61000-4-5 (Surge)
	IEC61000-4-6 (CS)
	IEC61000-4-8 (Magnetic Field)
Free Fall	IEC60068-2-32
Shock	IEC61373
Vibration	IEC61373
Green	RoHS Compliant
Certifications	EN 50155
	EN 45545-2
MTBF	>100,000 hours
Warranty	5 Years

DIMENSIONS (Unit: mm)

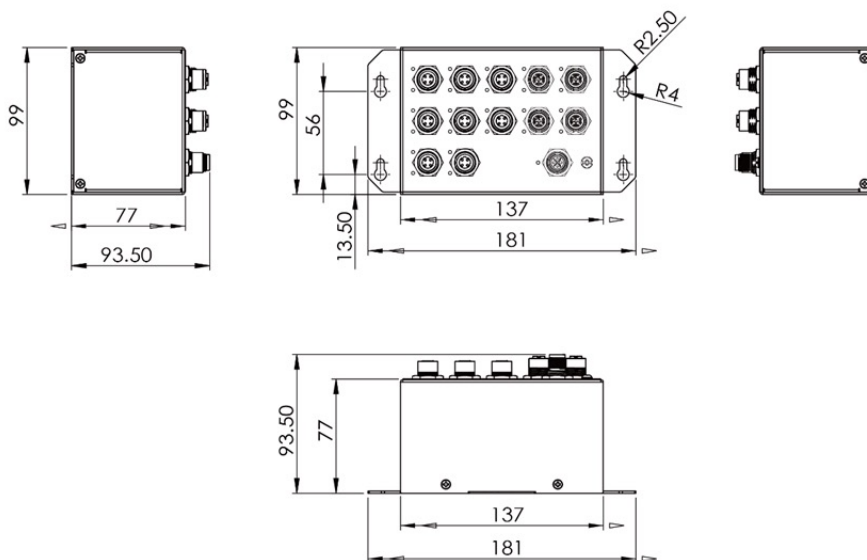

RPT-M1012P-4G-T-X2 | 12 Port Industrial Unmanaged PoE+ M12 Switch

Ordering Information	
<p>RPT-M1812P-4G-T-X2 (24VDC) RPT-M1012P-4G-LVDC-T-X2 (48VDC)</p>	<p>12 Port Industrial Unmanaged PoE+ Gigabit M12 Switch</p> <ul style="list-style-type: none"> - 8 x 10/100T(x) 30W/port + 4 x 10/100/1000T(x) M12 connector - Power Input: 24VDC (48VDC optional) - Power Budget 190W - Operating Temperature: -40°C ~ 75°C (-40°F ~ 167°F) - Protection Class: IP40 - UL Compliant
<p>RPT-M1812P-4G-T-I54-X2 (24VDC) RPT-M1012P-4G-LVDC-T-I54-X2 (48VDC)</p>	<p>12 Port Industrial Unmanaged PoE+ Gigabit M12 Switch</p> <ul style="list-style-type: none"> - 8 x 10/100T(x) 30W/port + 4 x 10/100/1000T(x) M12 connector - Power Input: 24VDC (48V DC optional) - Power budget 190W - Operating Temperature: -40°C ~ 75°C (-40°F ~ 167°F) - Protection Class: IP54 - UL Compliant
<p>RPT-M1012P-4G-HVDC-T-X2</p>	<p>12 Port Industrial Unmanaged PoE+ Gigabit M12 Switch</p> <ul style="list-style-type: none"> - 8 x 10/100T(x) 30W/port + 4 x 10/100/1000T(x) M12 connector - Power Input: 72-110VDC - Power Budget 156W - Operating Temperature: -40°C ~ 75°C (-40°F ~ 167°F) - Protection Class: IP40 - UL Compliant
<p>RPT-M1012P-4G-HVDC-I54-T-X2</p>	<p>12 Port Industrial Unmanaged PoE+ Gigabit M12 Switch</p> <ul style="list-style-type: none"> - 8 x 10/100T(x) 30W/port + 4 x 10/100/1000T(x) M12 connector - Power Input: 72-110VDC - Power Budget 156W - Operating Temperature: -40°C ~ 75°C (-40°F ~ 167°F) - Protection Class: IP54 - UL Compliant