

RPT-M1012P-4G-T-X2

12 Port Industrial Unmanaged PoE+ M12 Switch



FEATURE HIGHLIGHTS

- 8x 10/100T(x) M12 connector with IEEE 802.3at PoE+
- 4x 10/100/1000T(x) M12 connector
- Support Bypass function
- IP40/IP54(Optional) housing
- EN50155, EN45545-2 railway certificates
- Compliant with ITxPT, E Mark for public transport
- Operating in wide temperature
- Isolated redundant PoE power 190W

DESCRIPTION

Sbjlink's RPT-M1012P-4G, featuring 8 x Fast Ethernet ports and 4 x Gigabit uplink ports, are all designed with M12 connectors for vehicle application. The 8 fast ethernet ports provide 30W per port for PoE function. The 4 giga uplink ports with relay bypass function support non-stop communication while no power exists.

The power input of RPT-M1012P-4G has redundant dual power inputs supporting 24-48VDC for most of the vehicles and high power input version, between 72V-110VDC. Operating temperature is extended between -40 degree C and 75 degree C. These are applicable on the vehicles and railway application.

To fit the on-board installation, the enclosure is slim and compact with IP40 and IP54 housing options. RPT-M1012P-4G series all have EN50155 and EN45545-2 certificates for railway and E Mark for bus application. ITxPT is also design compliant to increase the interoperability with IT network for public transport.

This switch can be an purely unmanaged switch without PoE and capable to modify into a web smart switch that enable IEEE 802.3x and provide flow control function.

RPT-M1012P-4G-T-X2 | 12 Port Industrial Unmanaged PoE+ M12 Switch

SPECIFICATIONS

| Technology | |
|---------------------------|--|
| Standards | IEEE 802.3 10BaseT |
| | IEEE 802.3u 100BaseTX |
| | IEEE 802.3ab 1000BaseT |
| | IEEE 802.3f Power over Ethernet |
| | IEEE 802.3t PoE+ |
| Processing Type | Store and Forward |
| Switch Properties | |
| Switch Fabric | 9.6Gbps |
| Priority Queues | - |
| MAC Table Size | 8K |
| Packet Buffer | 4Mbits |
| Interface | |
| Network Connector | 8 x 10/100T(x) M12 Female D-coded 4-pole, 4x 10/100/1000T(x) M12 Female X-coded 8-pole, auto negotiation speed duplex mode, auto MDI/MDI-X |
| LED Indicators | Per unit: PWR1, PWR2, Status |
| | Ports: Link/Active |
| | PoE: Output Power |
| Power Requirements | |
| Operation Voltage | LV: 24VDC, 48VDC, HV: 72-110VDC Redundant dual inputs |
| Connection | M12 Male S-coded 4-pole |
| Power Consumption | 15W without PD's consumption |
| PoE Power Budget | Max. 30W per PoE port. Max. total output power for PD: 165W/100W@24V input (normal temp.); 75W@24V input (75°C) |
| Protection | Overload Current Protected, Reverse Polarity Protected |
| Mechanical Construction | |
| Enclosure | SECC |
| Protection Class | IP40/IP54(Optional) |
| Dimensions | 181x99x94 mm (WxHxD) |
| Weight | 1.20 kg |
| Mounting | Wall Mounting Kits, Optional DIN-Rail Mounting |
| Environmental Limits | |
| Operating Temperature | Extended: -40°C ~ 75°C (-40°F ~ 167°F) |
| Storage Temperature | -40°C ~ 85°C (-40°F ~ 185°F) |
| Ambient Relative Humidity | 5 to 95%, (Non-Condensing) |

RPT-M1012P-4G-T-X2 | 12 Port Industrial Unmanaged PoE+ M12 Switch

SPECIFICATIONS

| Regulatory Approvals | |
|----------------------|-------------------------------|
| EMI | FCC Part 15 Subpart B Class A |
| | CE EN 55032 Class A |
| EMS | IEC61000-4-2 (ESD) |
| | IEC61000-4-3 (RS) |
| | IEC61000-4-4 (EFT) |
| | IEC61000-4-5 (Surge) |
| | IEC61000-4-6 (CS) |
| | IEC61000-4-8 (Magnetic Field) |
| Free Fall | IEC60068-2-32 |
| Shock | IEC61373 |
| Vibration | IEC61373 |
| Green | RoHS Compliant |
| Certifications | EN 50155 |
| | EN 45545-2 |
| MTBF | >100,000 hours |
| Warranty | 5 Years |

DIMENSIONS (Unit: mm)

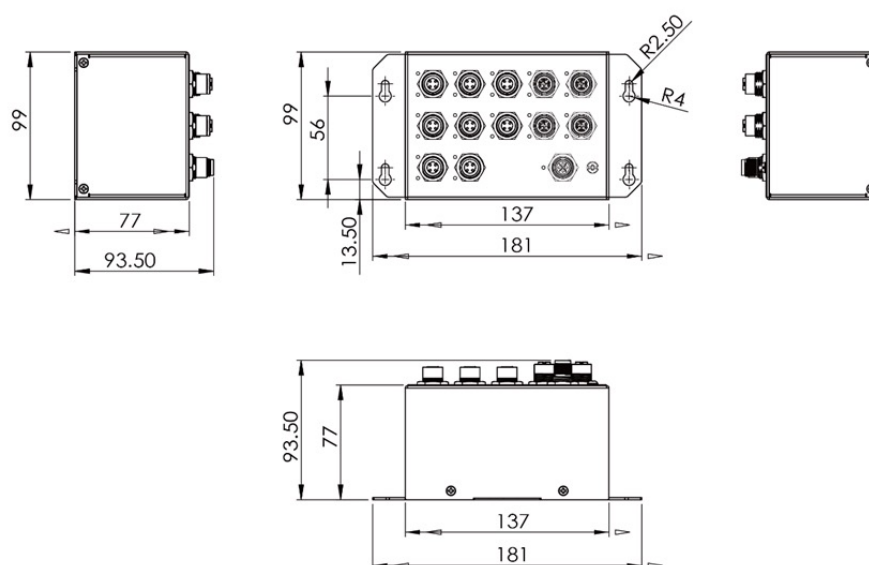

RPT-M1012P-4G-T-X2 | 12 Port Industrial Unmanaged PoE+ M12 Switch

Ordering Information

| | |
|---|---|
| <p>RPT-M1812P-4G-T-X2 (24VDC) RPT-M1012P-4G-LVDC-T-X2 (48VDC)</p> | <p>12 Port Industrial Unmanaged PoE+ Gigabit M12 Switch</p> <ul style="list-style-type: none"> - 8 x 10/100T(x) 30W/port + 4 x 10/100/1000T(x) M12 connector - Power Input: 24VDC (48VDC optional) - Power Budget 100W - Operating Temperature: -40°C ~ 75°C (-40°F ~ 167°F) - Protection Class: IP40 - UL Compliant |
| <p>RPT-M1812P-4G-T-I54-X2 (24VDC) RPT-M1012P-4G-LVDC-T-I54-X2 (48VDC)</p> | <p>12 Port Industrial Unmanaged PoE+ Gigabit M12 Switch</p> <ul style="list-style-type: none"> - 8 x 10/100T(x) 30W/port + 4 x 10/100/1000T(x) M12 connector - Power Input: 24VDC (48V DC optional) - Power budget 100W - Operating Temperature: -40°C ~ 75°C (-40°F ~ 167°F) - Protection Class: IP54 - UL Compliant |
| <p>RPT-M1012P-4G-HVDC-T-X2</p> | <p>12 Port Industrial Unmanaged PoE+ Gigabit M12 Switch</p> <ul style="list-style-type: none"> - 8 x 10/100T(x) 30W/port + 4 x 10/100/1000T(x) M12 connector - Power Input: 72-110VDC - Power Budget 100W - Operating Temperature: -40°C ~ 75°C (-40°F ~ 167°F) - Protection Class: IP40 - UL Compliant |
| <p>RPT-M1012P-4G-HVDC-I54-T-X2</p> | <p>12 Port Industrial Unmanaged PoE+ Gigabit M12 Switch</p> <ul style="list-style-type: none"> - 8 x 10/100T(x) 30W/port + 4 x 10/100/1000T(x) M12 connector - Power Input: 72-110VDC - Power Budget 100W - Operating Temperature: -40°C ~ 75°C (-40°F ~ 167°F) - Protection Class: IP54 - UL Compliant |